

NOOSA REGIONAL GALLERY – FLOOR PLAN

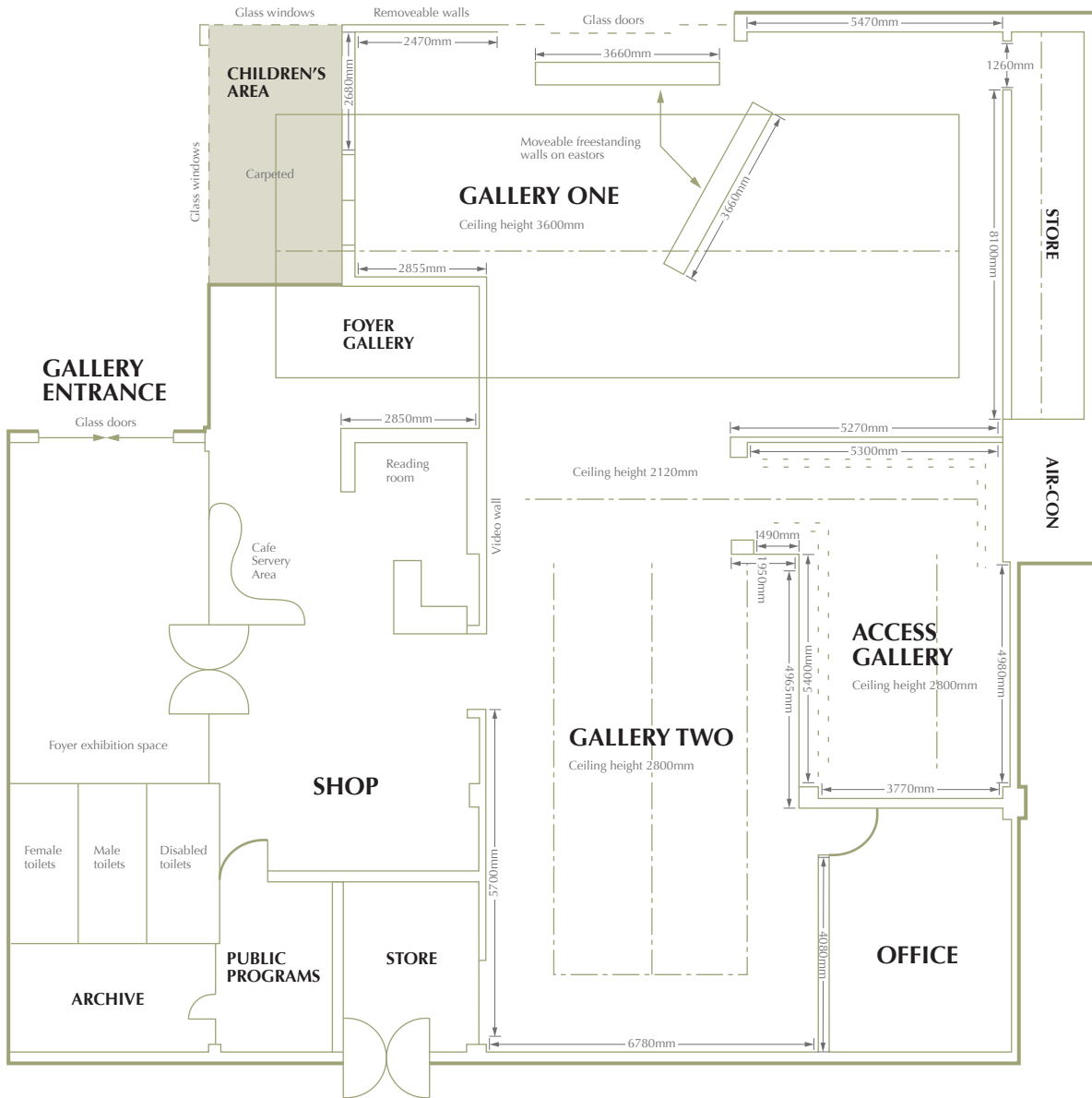

- Gallery 1** 41.5m running (approx), including removable walls
- Gallery 2** 23.5m running (approx)
- Access Gallery** 21m running
- Walls** Steel Stud and plasterboard (except where indicated)
- Ceiling Height** Gallery 1 – 3.60m
Gallery 2 – 2.80m
Access – 2.80m with lower sections 2.12m
- Light Track
- Flourescent hanging lights